

## TRONIC RX

120 V - 60 Hz

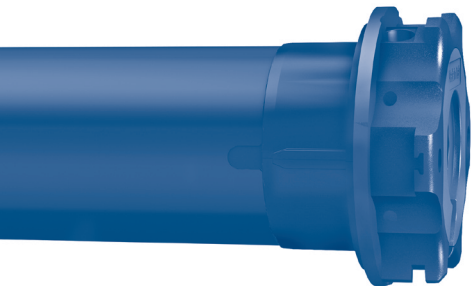

MOTORE TUBOLARE PER AVVOLGIBILI CON  
FINECORSO ELETTRONICO

**IT**

TUBULAR MOTOR WITH ELECTRONIC LIMIT SWITCH  
FOR ROLLING SHUTTERS

**EN**

ROHRMOTOR FÜR ROLLADEN MIT  
ELEKTRONISCHER ENDLAGENEINSTELLUNG

**DE**

MOTEUR TUBULAIRE POUR VOLET ROULANT  
AVEC FINS DE COURSE ÉLECTRONIQUES

**FR**

MOTOR TUBULAR PARA PERSIANA CON  
FIN DE CARRERA ELECTRÓNICO

**ES**



**Table of contents:**

How to prepare the motor .....	p. 27
Electrical connections .....	p. 28
Compatible remote controls.....	p. 29
Key to symbols .....	p. 30
Command sequences example .....	p. 31
Function open/close programming remote control .....	p. 32-33
Setting the first remote control .....	p. 34
Automatic disabling of the first remote control setting function .....	p. 34
Adjustment of the limit switches .....	p. 34
Setting in mode 1 ( <b>manual</b> ) .....	p. 34
Example 1: Setting first the opening position .....	p. 35
Example 2: Setting first the closing position .....	p. 36
Mode 2: limit switch setting ( <b>semi-automatic</b> ) .....	p. 37
Deleting the middle position .....	p. 38
Deleting the opening and closing limit switch .....	p. 38
Closing force adjustment .....	p. 39
Maximum closing force adjustment (100%) .....	p. 39
<b>Deleting the limit switch positions</b> .....	p. 40
Deleting the opening limit switch .....	p. 40
Deleting the closing limit switch .....	p. 40
Total deleting of the limit switches .....	p. 40
Setting of additional remote controls .....	p. 41
Remote control memory clearing .....	p. 41
Full memory clearing .....	p. 42
<b>Special functions:</b>	
Short-term setting of a remote control .....	p. 43
Setting the A530058 pocket remote control .....	p. 44
Electric wiring to motor command with 2 independent buttons .....	p. 45
Command management from white wire	
UP-STOP-DOWN-STOP / UP-DOWN / UP-DOWN "Dead Man" .....	p. 46
Super-sensitivity obstacle detection management during downwards movements (only for Ø 35 motors) .....	p. 47
"Furniture" function .....	p. 47-48
EU Declaration of conformity .....	p. 118

## HOW TO PREPARE THE MOTOR

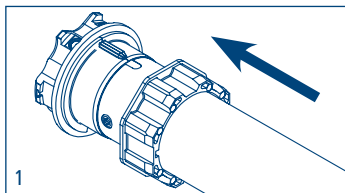
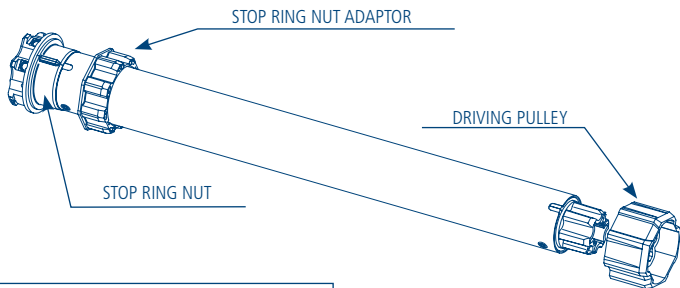

1. Insert the adaptor in the stop ring nut mating the groove with the reference notch and push till they touch.

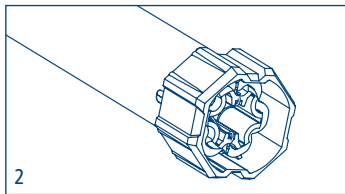

2. Fix the driving pulley on the motor pin until the stop pin clicks.

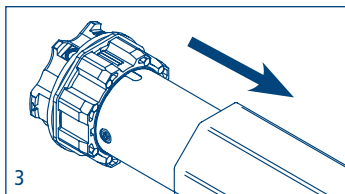

3. Insert the motor fully in the rolling tube.

**NB:** If you use tubes with a round form, the driving pulley must be fixed to the tube, and the installation is to be paid by the person who installs the system. For other tube sections the fitting is optional, but strongly recommended.

## ELECTRICAL CONNECTIONS

- In order to prevent dangerous situations or malfunctioning, the electrical command elements wired to the motor must be sized according to the motor's electrical features.
- Means for disconnection must be incorporated in the fixed wiring in accordance with the national installation standards.
- For outdoor use, provide the appliance with a supply cable with designation H05RN-F containing at least 2% of carbon.
- If not used, the red wire must be insulated. It is dangerous to touch the red wire when the motor is powered.

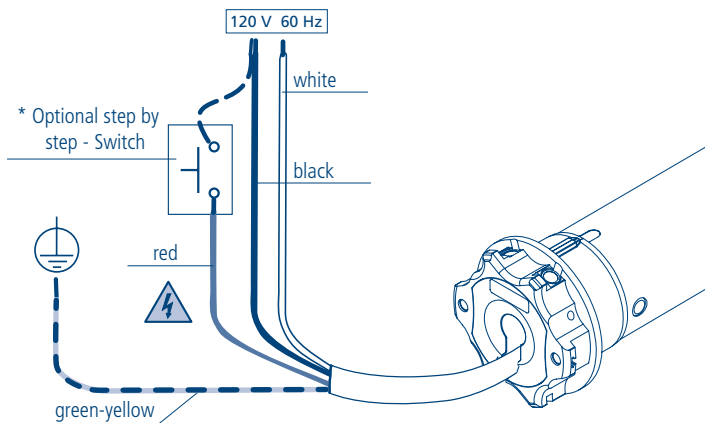

\* Installing this button is optional. The connection can be done differently using the black wire or the white wire. The button affords the possibility to command the motor in stepping mode (up, stop, down, stop, up, stop, down, stop..)

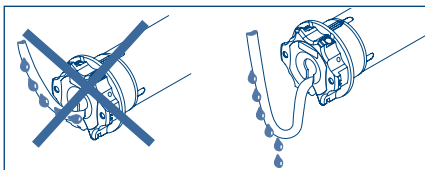

## COMPATIBLE REMOTE CONTROLS

### GIRO

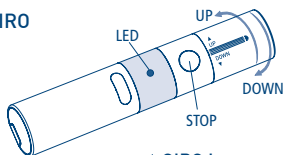

### GIRO Wall

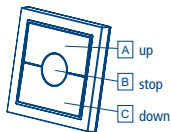

### GIRO Plus

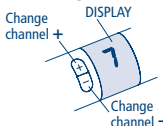

### GIRO Lux

Activating the Sun sensor

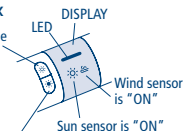

Deactivating the Sun sensor

### GIRO P-Lux

Change channel

DISPLAY

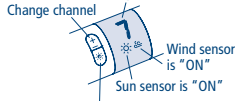

Activating/ Deactivating the Sun sensor

### POP

### POP Lux

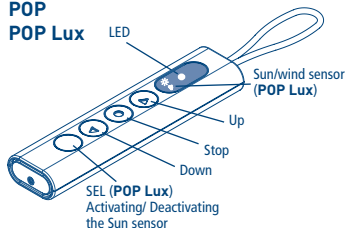

### POP Plus

### POP P-Lux

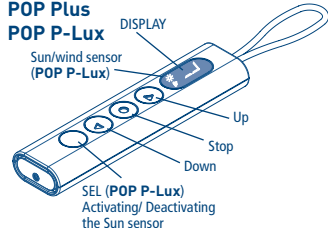

SKIPPER  
SKIPPER Lux  
SKIPPER Plus  
SKIPPER P-Lux

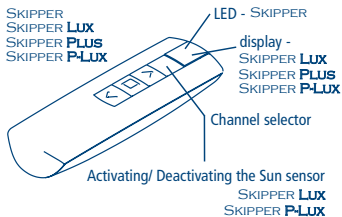

SKIPPER LCD  
SKIPPER SENSO

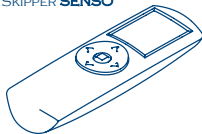

Check the specific instruction book

A530058 Remote Control with 4 independent channels



## KEY TO SYMBOLS

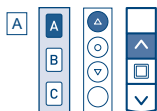
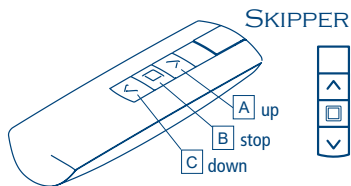
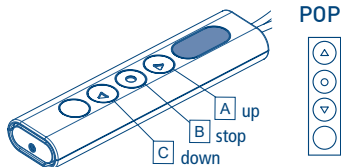
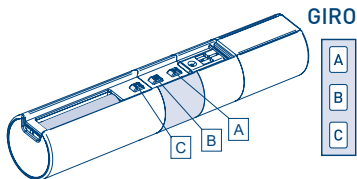
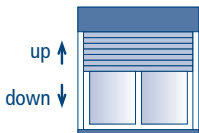

Press button A

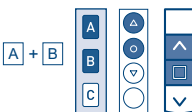

Press buttons A and B  
at the same time



Press the  
bottom  
UP



Press the  
bottom  
DOWN



Release



short motor rotation  
in one direction



long motor rotation  
in other direction



double short  
rotation

## COMMAND SEQUENCES EXAMPLE

Most of the command sequences have three distinct steps, at the end of which the motor indicates if the step has been concluded positively or not, by turning in different ways. This section is provided to demonstrate the motor indications. The buttons must be pressed as shown in the sequence, without taking more than 4 seconds between one step and the next. If more than 4 seconds are taken, the command is not accepted and the sequence must be repeated.

Command sequence example:

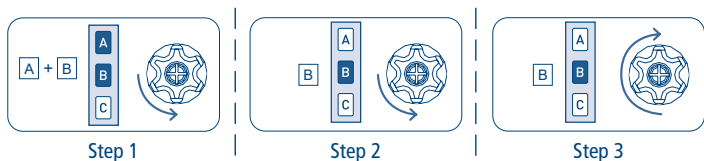

As we can see from the example, when the sequence ends positively, the motor returns to its starting position in one long rotation. In fact, two short rotations in the same direction correspond to one long rotation in the opposite direction. The motor returns to the starting position even when the sequence is not completed; in this case by performing one or two short rotations.

Example of a wrong sequence:

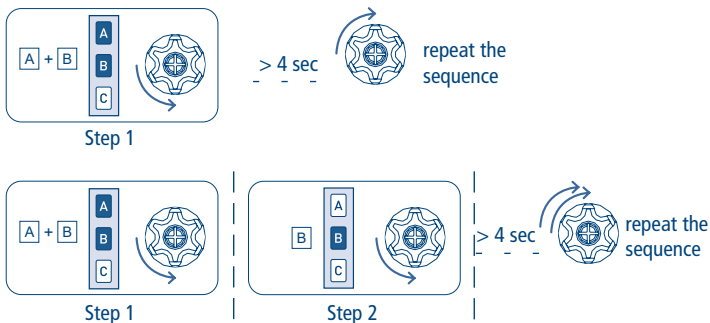



# FUNCTION OPEN/CLOSE PROGRAMMING

## REMOTE CONTROL SKIPPER PLUS - SKIPPER LUX - SKIPPER P-LUX

## REMOTE CONTROL POP PLUS - POP LUX - POP P-LUX

To prevent accidental changes to the programming of the motor during the daily use of the remote control, the possibility of programming is disabled automatically 8 hours after sending the last sequence (A+B or B+C).

### CHECKING THE STATUS OF THE FUNCTION

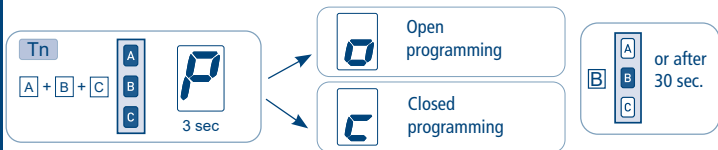

To change the status of the function, see the sequences "ENABLE/DISABLE PROGRAMMING".

### ENABLE PROGRAMMING

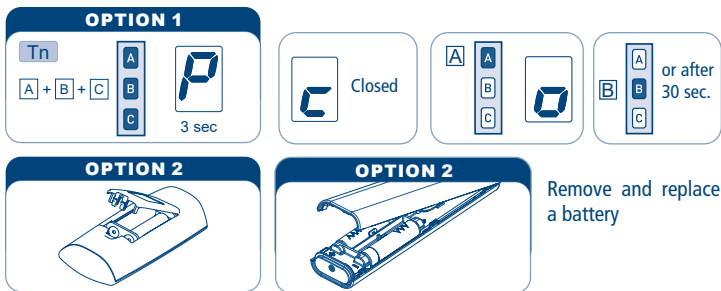

Proceed with programming as the instructions booklet.

### DISABLE PROGRAMMING



## FUNCTION OPEN/CLOSE PROGRAMMING

### REMOTE CONTROL SKIPPER - SERIES GIRO - REMOTE CONTROL POP

To prevent accidental changes to the programming of the motor during the daily use of the remote control, the possibility of programming is disabled automatically 8 hours after sending the last sequence (A+B or B+C).

#### CHECKING THE STATUS OF THE FUNCTION

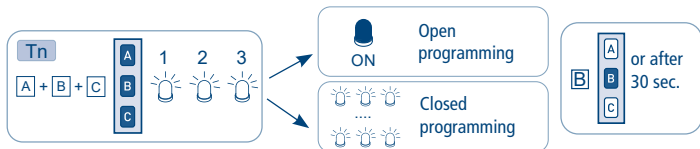

To change the status of the function, see the sequences "ENABLE/DISABLE PROGRAMMING".

#### ENABLE PROGRAMMING

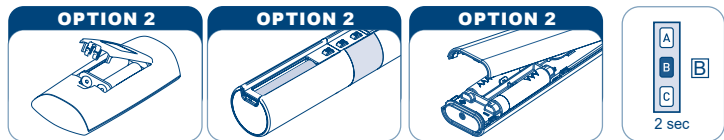
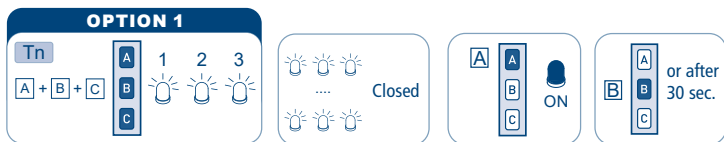

Remove one battery and wait minimum 5 seconds or press any button.

Proceed with programming as the instructions booklet.

#### DISABLE PROGRAMMING



## SETTING THE FIRST REMOTE CONTROL

This operation can only be performed when the motor is new, or after a total delete of the memory.

**During this step, power up only one motor at time!**

T1: First remote control to be set

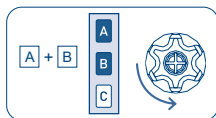

T1

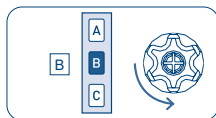

T1

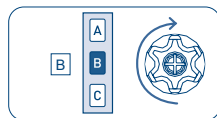

T1 (2 sec)

### AUTOMATIC DISABLING OF THE FIRST REMOTE CONTROL SETTING FUNCTION

Every time you connect the power supply to the motor, you have 3 hours to store the first remote control. After this time, the ability to store the remote control is disabled. To reset the timer of the function you have to disconnect and reconnect the power supply to the motor.

### ADJUSTMENT OF THE LIMIT SWITCHES

Tronic RX tubular motors have an electronic limit switch system with an encoder. This system ensures great reliability and precision in keeping the positions. Limit switch regulation is performed simply with the remote control. During setting, the motor moves only as long as the up or down button is pressed, stopping when the button is released. At the end of setting, press either the up or down button briefly to move the motor. The adjustments of the limit switches can be done in different modes depending on whether the rolling shutter is equipped with lockdown hangers or physical stops.

### SETTING IN MODE 1 (manual)

In this mode it doesn't matter whether or not the rolling shutter has got physical stops in the opening position and the lockdown hangers in the closing position. It is possible to choose whether to set the upper limit or the lower limit first. The correct rotation direction will only be identified after the first position is set so it is sometimes necessary to use the "up" or "down" button.

## EXAMPLE 1: Setting first the opening position

### SETTING THE OPENING POSITION

If the rolling shutter is completely open, you have first to drive it down by around 20 cm.

Hold the button A or C pressed and drive the rolling shutter to the opening position.

**With physical stops:** press button A or C until the motor stops automatically.

**Without physical stops:** use the button A or C to drive the rolling shutter to the necessary opening position.

To set the opening position, press buttons A (up) and B (stop) simultaneously for about 2 seconds, until the motor automatically performs a short "down" movement.

This move is the visual confirmation of the setting operation.

Tn: Already programmed remote control

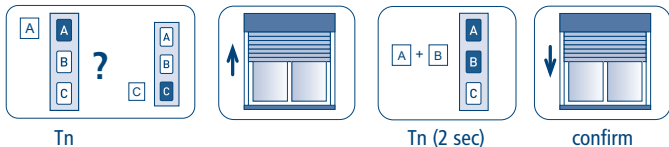

### SETTING THE CLOSING POSITION

Pressing now the button C, drive completely down the rolling shutter to the closing position.

**With lockdown hangers:** press button C until the motor stops automatically.

**Without lockdown hangers:** use the button A or C to drive the rolling shutter to the necessary closing position.

To set the closing position, press buttons B (stop) and C (down) simultaneously for about 2 seconds, until the motor automatically performs a short "up" movement.

This move is the visual confirmation of the setting operation.

Tn: Already programmed remote control

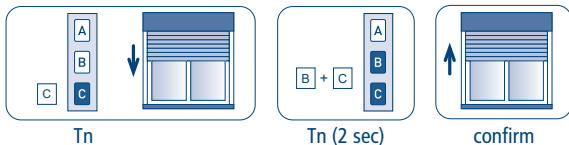

## EXAMPLE 2: Setting first the closing position

### SETTING THE CLOSING POSITION

If the rolling shutter is completely closed, you have first to drive it up by around 20 cm.

Hold the button A or C pressed and drive the rolling shutter to the closing position.

**With lockdown hangers:** press buttons A or C until the motor stops automatically.

**Without lockdown hangers:** use the button A or C to drive the rolling shutter to the necessary closing position.

To set the closing position, press buttons B (stop) and C (down) simultaneously for about 2 seconds, until the motor performs automatically a short "up" movement.

This move is the visual confirmation of the setting operation.

Tn: Already programmed remote control

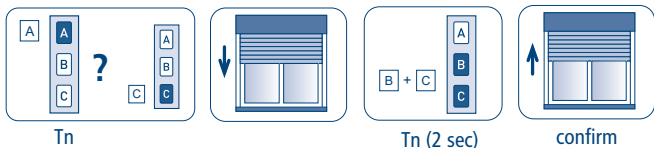

### SETTING THE OPENING POSITION

Pressing now button A, drive completely up the rolling shutter to the opening position.

**With physical stops:** press button A until the motor stops automatically.

**Without physical stops:** use the button A or C to drive the rolling shutter to the necessary opening position.

To set the opening position, press buttons A (up) and B (stop) simultaneously for about 2 seconds, until the motor automatically performs a short "down" movement.

This move is the visual confirmation of the setting operation.

Tn: Already programmed remote control

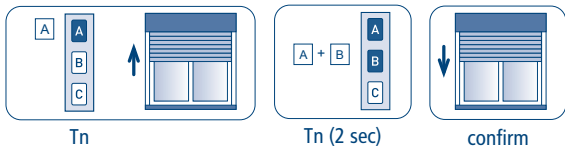

## MODE 2: LIMIT SWITCH SETTING (semi-automatic)

To do the settings in this mode the rolling shutter has to be equipped with lockdown hangers in the closing position, but the rolling shutter does not need to have physical stops in the opening position. This mode of setting is helpful in cases where the factory will set the opening position and the closing position will be set automatically during the normal use.

**In this mode, it's necessary to set first the opening position!! (Rolling shutter open!)**

### SETTING THE OPENING POSITION

**If the shutter is already completely open, you have first to drive it down by about 20 cm.**

Press button A or C and drive the rolling shutter to the opening position.

**With physical stops:** press button A or C until the motor stops automatically.

**Without physical stops:** use buttons A and C to drive the rolling shutter to the necessary opening position.

To set the opening position, press button B (stop) for about 2 seconds, until the motor performs a short downwards movement. After this confirmation movement the motor brings back the rolling shutter to the opening position.

Tn: Already programmed remote control

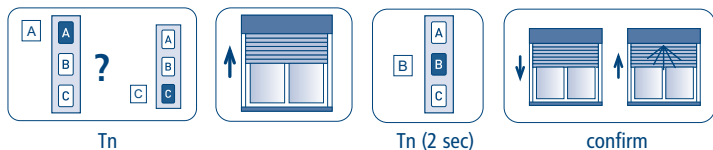

Now the drive direction is detected and the motor can be disconnected from the power. The closing position will be set automatically during the normal use. When the motor is powered up again, the remote control can be used normally. The lower limit switch position will be set automatically the first time the rolling shutter stops automatically in the closing position using the lock down hangers. As the motor looks for a "mechanical" stop during each way down, if the Obstacle Recognition finds something is blocking the way (such as a protruding screw in the guide rails), it is necessary to raise the shutter again, remove the obstacle and to drive the motor back to the closing position to set the limit.

## SETTING A MIDDLE POSITION

This function allows the rolling shutter to be set at a favourite middle position. When this middle position is memorized, you just press the stop button for 2 seconds and automatically the motor will move the shutter to this position.

To memorize the middle position, move the rolling shutter to the desired position and then hold the STOP button down (for about 2 sec) until the motor gives confirmation.

Tn: Already programmed remote control



Tn (4 sec)

### MOVEMENT TO MIDDLE POSITION

It's possible to control the motor in the middle position in two ways:

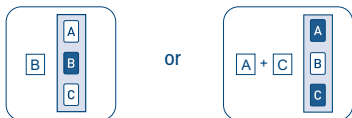

Tn (2 sec)

## DELETING THE MIDDLE POSITION

If you want to delete the middle position, it can be done as described below.

To change this position, it's also necessary to delete first the memorized middle position. Before deleting it's necessary to drive the motor to the middle position (by pressing button B for 2 seconds), then press again button B (stop) for about 4 seconds until the motor confirms the operation by a longer movement.

Tn: Already programmed remote control

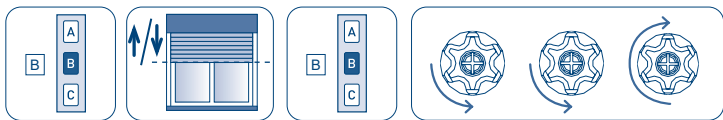

Tn (2 sec)

Tn (4 sec)

## CLOSING FORCE ADJUSTMENT

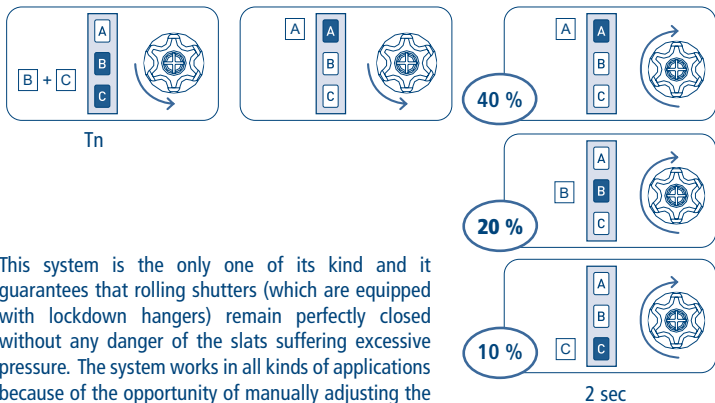

This system is the only one of its kind and it guarantees that rolling shutters (which are equipped with lockdown hangers) remain perfectly closed without any danger of the slats suffering excessive pressure. The system works in all kinds of applications because of the opportunity of manually adjusting the closing force.

The Tronic RX is factory set to a closing force of 20 % of the nominal torque. This force can be changed very easily by the remote control. It can be reduced by 10 % or increased up to 40 %, depending on the desired result.

### MAXIMUM CLOSING FORCE ADJUSTMENT (100%)

A close attention on activating this function is recommended, excessive closing force may damage the rolling shutters.

By activating this function the motor will apply its maximum nominal torque, (e.g. 100% of 50 Nm = 50 Nm).

Tn: Already programmed remote control

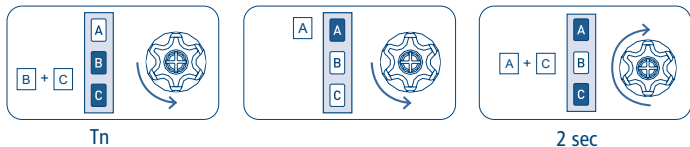



## DELETING THE LIMIT SWITCH POSITIONS

### DELETING THE OPENING LIMIT SWITCH

To delete only the opening limit switch perform the following steps and proceed with "SETTING THE OPENING POSITION".

Tn: Already programmed remote control

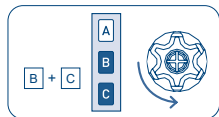

Tn

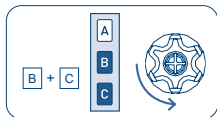

Tn

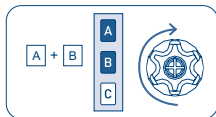

Tn (2 sec)

### DELETING THE CLOSING LIMIT SWITCH

To delete only the closing limit switch perform the following steps and proceed with "SETTING THE CLOSING POSITION".

Tn: Already programmed remote control

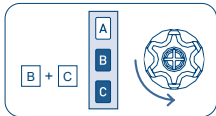

Tn

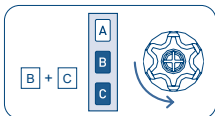

Tn

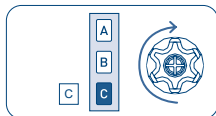

Tn (2 sec)

### TOTAL DELETING OF THE LIMIT SWITCHES

Tn: Already programmed remote control

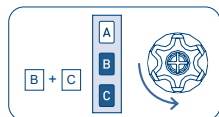

Tn

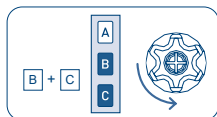

Tn

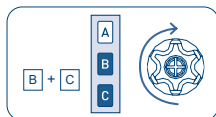

Tn (4 sec)

**NB:** by deleting the limit switches, the setting of the closing force is maintained.

## SETTING OF ADDITIONAL REMOTE CONTROLS

Up to 15 remote controls can be set.

Tn: Already programmed remote control

Tx: Additional remote control

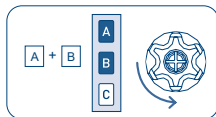

Tn

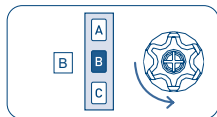

Tn

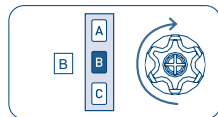

Tx (2 sec)

## REMOTE CONTROL MEMORY CLEARING

It is possible to delete singly all the memorized remote controls. When the last one is deleted the motor initial condition is restored. The same applies to the single channels of a multichannel remote control: just select the channel to cancel before performing the sequence.

Tn: Remote control to be cleared

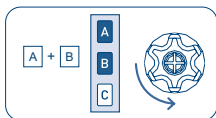

Tn

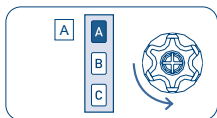

Tn

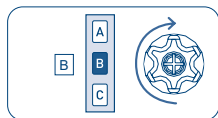

Tn (2 sec)

## FULL MEMORY CLEARING

This full memory clearing does not delete the setting of the limit switch.

The full memory clearing can be performed in two ways:

### 1) WITH THE REMOTE CONTROL

Tn: Already programmed remote control

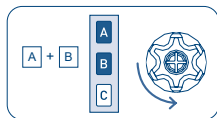

Tn

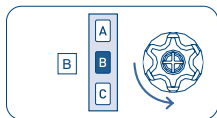

Tn

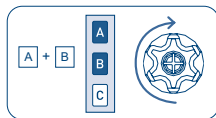

Tn (4 sec)

### 2) WITH THE RED WIRE

Do this operation only in case of emergency, if all remote controls are no longer operating.

To delete the memory we have to access the red wire of the motor.

The sequence of this operation is the following:

- 1) Disconnect the power supply from the motor, via the main switch for example.
- 2) Connect the red motor wire to the black wire (phase) or to the white wire (neutral).
- 3) Connect the power supply to the motor, which rotates briefly in one direction.
- 4) Disconnect the power supply from the motor for at least 4 seconds.
- 5) Connect the power supply to the motor which performs one brief rotation in one direction after around 4 seconds and then a longer one in the opposite direction.
- 6) Disconnect the power supply from the motor.
- 7) Separate the red wire from the black/white wire. Insulate the red wire, in an appropriate way, before reconnecting the power supply.

At this point it is possible to proceed with the setting of the first remote control.

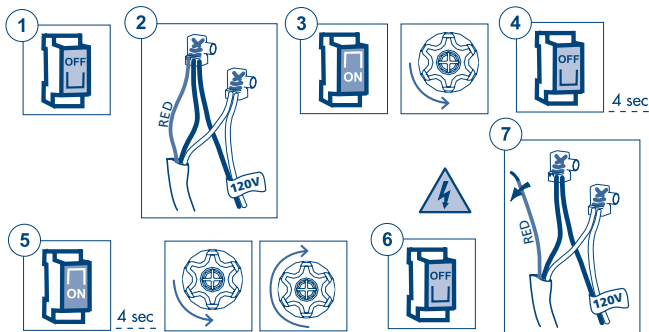

## SPECIAL FUNCTIONS

### SHORT-TERM SETTING OF A REMOTE CONTROL

This function makes it possible to store a remote control temporarily, for example, with the purpose of setting the limit switches during assembly in the factory. A later final saving of the remote control will be possible using the appropriate command sequence (see: "SETTING THE FIRST REMOTE CONTROL"). The operations described below can be carried out only when the motor has just come out of the factory or after a full memory clearing (see: "FULL MEMORY CLEARING"). The motor makes the following operations possible only within the time limits described in order to make sure that the short-term setting is used only in the installation or factory setting phase and not during daily use. Power up the motor, make sure that no other motors having an empty memory are powered up in the same operating range.

**Within 30 seconds after start**, press the B and C buttons simultaneously until the motor gives a confirmation signal.

**The remote control will remain stored for 5 minutes**, while the motor is powered up. After 5 minutes or when the motor has its power cut off, the remote control will be cancelled.

T1: First remote control to be set

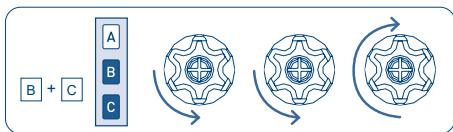

T1

## SETTING THE A530058 POCKET REMOTE CONTROL

NB: The new pocket remote control can be set only after programming of a previous remote control as the traditional Cherubini remote controls (Skipper, Giro or POP - 3 buttons Up-Down-Stop remote control).

### HOW TO PROCEED TO SET THE BUTTON ON THE POCKET REMOTE CONTROL

Tn: Already programmed remote control

Tx: Pocket remote control to be set

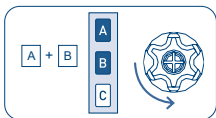

Tn

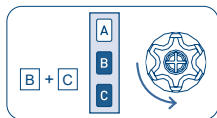

Tn

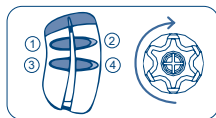

Tx (2 sec)

After to have pressed for minimal 2 seconds one of the 4 buttons on the pocket remote control, this one will be memorized on the step-by-step mode (UP-STOP-DOWN-STOP). The following buttons will be not memorized and have to be done with previous described sequence, and could be used to move additional Tronic RX motors.

### DELETING ONE BUTTON ON THE POCKET REMOTE CONTROL

The buttons saved may be deleted individually according to the following sequence:

Tn: Already programmed remote control

Tx: Pocket remote control with button to be deleted

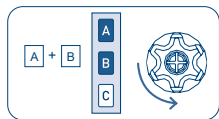

Tn

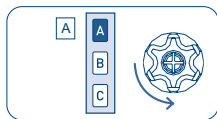

Tn

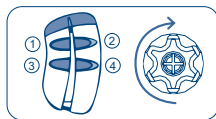

Tx (2 sec)

To confirm the operation the motor will do a short shunt and the button, which has to be pressed for minimal 2 second, will be deleted.

## ELECTRIC WIRING TO MOTOR COMMAND FOR UP-DOWN MODE (2 independent UP-DOWN buttons)

To connect the switch, use only kind of switches with mechanical or electrical interlock, to prevent to press both buttons at same time.

The motor automatically recognizes the switch-type (with 1 or 2 buttons) and sets the proper operational mode.

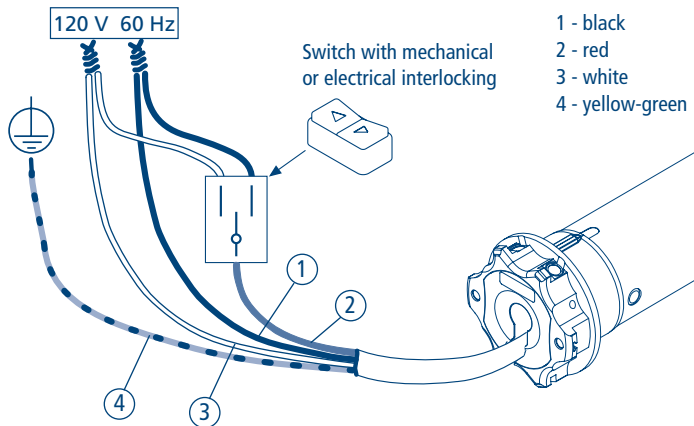

From white wire it's possible to control the motor in the middle position:

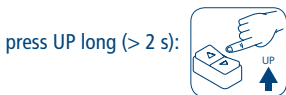

or use the short UP sequence (< 0,5 s) - short DOWN (< 0,5 s)



Using the switch as described on this page it's possible to set the motor trough the red wire (WIRE PROGRAMMING).

To find out this procedure, require the instruction pamphlet from your dealer.

## COMMAND MANAGEMENT FROM WHITE WIRE

### UP-STOP-DOWN-STOP / UP-DOWN / UP-DOWN "DEAD MAN"

NB: The default function provided in the motors leaving the factory is UP-STOP-DOWN-STOP for singular UP/DOWN button switch. (Not for the switch with two independent UP-DOWN buttons!)

PROCEDURE TO CHANGE THE CONTROL MODE:

Tn: Already programmed remote control

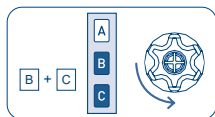

Tn

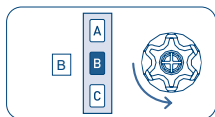

Tn

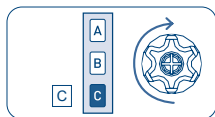

Tn (2 sec)

The possible settings are 3 and are available in the following order:

- UP-STOP-DOWN-STOP (factory setting)
- UP-DOWN (for 2 independent buttons)
- UP-DOWN "DEAD MAN" (for 2 independent buttons)

To switch from one setting to the following, perform the sequence as many times as necessary to reach the desired setting.

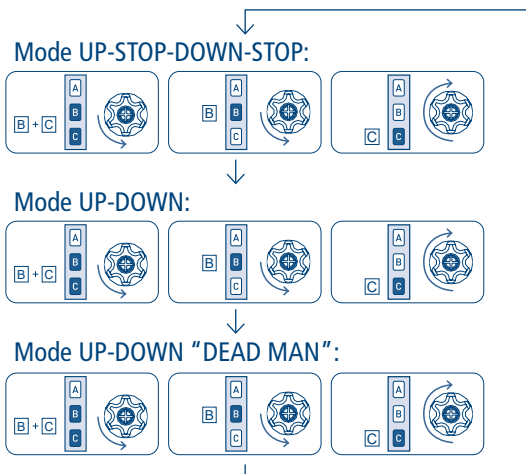

# SUPER-SENSITIVITY OBSTACLE DETECTION MANAGEMENT DURING DOWNWARDS MOVEMENTS

- only for Ø 35 motors -

Where required it is possible to activate/deactivate a high level of obstacle detection sensitivity during downwards movement. This Super-sensitivity is automatically disabled when the blinds slats begin to pile up.

## ACTIVATING THE SUPER-SENSITIVITY FUNCTION

Tn: Already programmed remote control

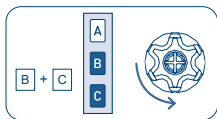

Tn

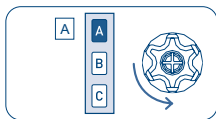

Tn

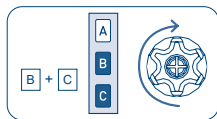

Tn (2 sec)

## ACTIVATION OF THE "FURNITURE" FUNCTION

The "Furniture" function is meant for special applications in the moving blinds sector. This should NOT be disabled in proximity to the lower limit switch position, and may be used only if the super-sensitivity function has already been activated.

Tn: Already programmed remote control

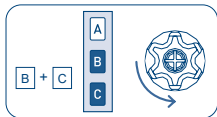

Tn

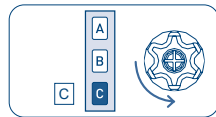

Tn

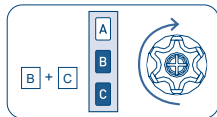

Tn (2 sec)

## DEACTIVATING THE SUPER-SENSITIVITY FUNCTION

Tn: Already programmed remote control

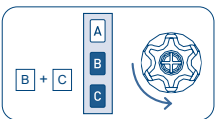

Tn

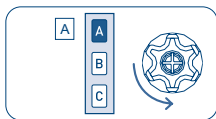

Tn

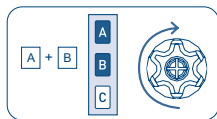

Tn (2 sec)

### ATTENTION

By deactivating the super-sensitivity function the "Furniture" function will automatically be deactivated.



## FORCED REMOTE CONTROL RE-PROGRAMMING WITH FURNITURE FUNCTION ACTIVE

If the remote control has been lost it's possible, by enabled "Furniture" function, to memorize a new remote control.

To memorize a new remote control proceed as follows:

- Disconnect the power supply.
- Connect again the power supply.

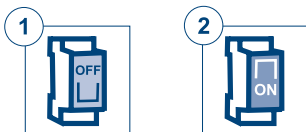

From now it's possible during 1 minute to memorize a new remote control.

T1: New first remote control to be programmed

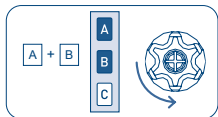

T1

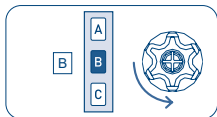

T1

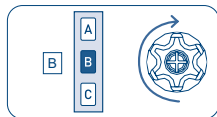

T1 (2 sec)

All previously programmed remote controls have been deleted.

## **IT DICHIARAZIONE DI CONFORMITÀ UE**

**CE** CHERUBINI S.p.A. dichiara che il prodotto è conforme alle pertinenti normative di armonizzazione dell'Unione:

Direttiva 2014/53/UE, Direttiva 2011/65/UE.

Il testo completo della dichiarazione di conformità UE è disponibile facendone richiesta sul sito: [www.cherubini.it](http://www.cherubini.it).

## **EN EU DECLARATION OF CONFORMITY**

**CE** CHERUBINI S.p.A. declares that the product is in conformity with the relevant Union harmonisation legislation:

Directive 2014/53/EU, Directive 2011/65/EU.

The full text of the EU declaration of conformity is available upon request at the following website: [www.cherubini.it](http://www.cherubini.it).

## **DE EU-KONFORMITÄTSERKLÄRUNG**

**CE** CHERUBINI S.p.A. erklärt der produkt erfüllt die einschlägigen Harmonisierungsrechtsvorschriften der Union:

Richtlinie 2014/53/EU, Richtlinie 2011/65/EU.

Der vollständige Text der EU-Konformitätserklärung kann unter unserer Web-Seite [www.cherubini.it](http://www.cherubini.it), gefragt werden.

## **FR DÉCLARATION UE DE CONFORMITÉ**

**CE** CHERUBINI S.p.A. déclare que le produit est conforme à la législation d'harmonisation de l'Union applicable:

Directive 2014/53/UE, Directive 2011/65/UE.

Le texte complet de la déclaration UE de conformité est disponible en faisant requête sur le site internet: [www.cherubini.it](http://www.cherubini.it).

## **ES DECLARACIÓN UE DE CONFORMIDAD**

**CE** CHERUBINI S.p.A. declara que el producto es conforme con la legislación de armonización pertinente de la Unión:

Diretiva 2014/53/UE, Directiva 2011/65/UE.

El texto completo de la declaración UE de conformidad puede ser solicitado en: [www.cherubini.it](http://www.cherubini.it).



**CHERUBINI S.p.A.**

Via Adige 55  
25081 Bedizzole (BS) - Italy  
Tel. +39 030 6872.039  
info@cherubini.it | www.cherubini.it

**CHERUBINI Iberia S.L.**

Avda. Unión Europea 11-H  
Apdo. 283 - P. I. El Castillo  
03630 Sax Alicante - Spain  
Tel. +34 (0) 966 967 504 | Fax +34 (0) 966 967 505  
info@cherubini.es | www.cherubini.es

**CHERUBINI France SAS**

ZI Du Mas Barbet  
165 Impasse Ampère  
30600 Vauvert - France  
Tél. +33 (0) 466 77 88 58  
info@cherubini.fr | www.cherubini.fr

**CHERUBINI Deutschland GmbH**

Siemensstrasse, 40 - 53121 Bonn - Deutschland  
Tel. +49 (0) 228 962 976 34 / 35 | Fax +49 (0) 228 962 976 36  
info@cherubini-group.de | www.cherubini-group.de

